

Upgrades to Memorial and Hirst Avenues

The City is pleased to announce detailed plans for future upgrades to Memorial and Hirst Avenues. These projects, planned for adjacent blocks of Memorial Avenue and Hirst Avenue West, will proceed together to allow for greater construction efficiency and cost savings. We look forward to bringing the community's vision for these spaces to life and anticipate both projects will see construction in 2021.

The Memorial Avenue design includes a new 9,000-square-foot plaza. A component of the City's downtown revitalization strategy, this space will be used year-round and will represent a dynamic venue for residents, visitors, businesses, and community organizations to celebrate and experience downtown Parksville.

Included with this release is a copy of the information board placed on site, which highlights the improved pedestrian facilities and lighting proposed for the area. The board also shows the increased focus on the health of the memorial trees as well as pedestrian safety and enjoyment; responsive to the feedback received during public engagement. A four-way stop at Hirst Avenue West at the Alberni Highway will be installed to allow all turning movements at this intersection and to further the City's goals of facilitating greater downtown connectivity.

The City will soon begin engaging with contractors to request proposals for this work with the goal to develop a well-coordinated plan which addresses continued access to businesses and residences, tree protection and construction staging. This should facilitate a less disruptive construction process and help us find the best value for our community. More info on this project at <https://letstalkparksville.ca/memorial-avenue-community-engagement>

###

For more information:

Deb Tardiff, Manager of Communications

dtardiff@parksville.ca; 250 954-3073

Memorial and Hirst Avenues Upgrades



What's happening and when?

The City of Parksville is planning to upgrade the utilities and streetscape of Memorial and Hirst Avenues between Alberni Highway and McMillan Street. Construction of the upgrades, including a new public square that will occupy the east end of Memorial Avenue, is anticipated to begin in early 2021. We can't wait to celebrate with the community and enjoy this space together!

Conceptual Rendering of Public Plaza



Proposed Public Plaza Detail

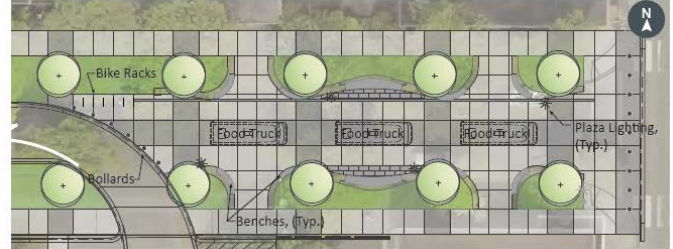

Plan View of The Proposed Memorial and Hirst Avenue West Streetscapes

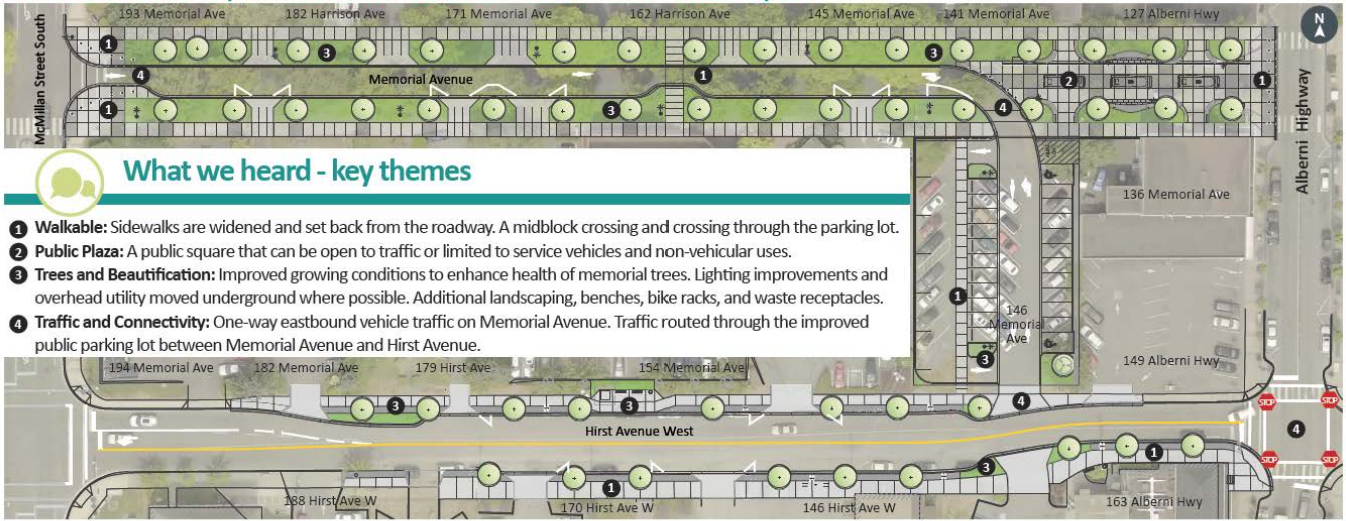

What we heard - key themes

- 1 **Walkable:** Sidewalks are widened and set back from the roadway. A midblock crossing and crossing through the parking lot.
- 2 **Public Plaza:** A public square that can be open to traffic or limited to service vehicles and non-vehicular uses.
- 3 **Trees and Beautification:** Improved growing conditions to enhance health of memorial trees. Lighting improvements and overhead utility moved underground where possible. Additional landscaping, benches, bike racks, and waste receptacles.
- 4 **Traffic and Connectivity:** One-way eastbound vehicle traffic on Memorial Avenue. Traffic routed through the improved public parking lot between Memorial Avenue and Hirst Avenue.



Where can I find more information?

To learn more about the project, visit MemorialAve.ca or contact the Engineering Department at Engineering@Parksville.ca or 250 951-2484.

