

New Bus Shelters to be Installed on Jensen at McCarter and at McMillan

Two new transit shelters will be located on Jensen Avenue West at McMillan Street and on Jensen Avenue East adjacent to the Parksville Community Centre and the McCarter intersection. Work on the installation of concrete pads to prepare for the installation of the new transit shelters will begin on November 5. Installation of the concrete pads is expected to take about one week with construction between 8 am to 4 pm, Monday to Friday.

Jensen Avenue West and McMillan Street

During construction, the bike lane and half of the right lane will be closed. Bikes and cars will be required to move left past the work zone and then merge right again. Pedestrians will be directed to cross intersections to south sidewalk on either side of work zone.

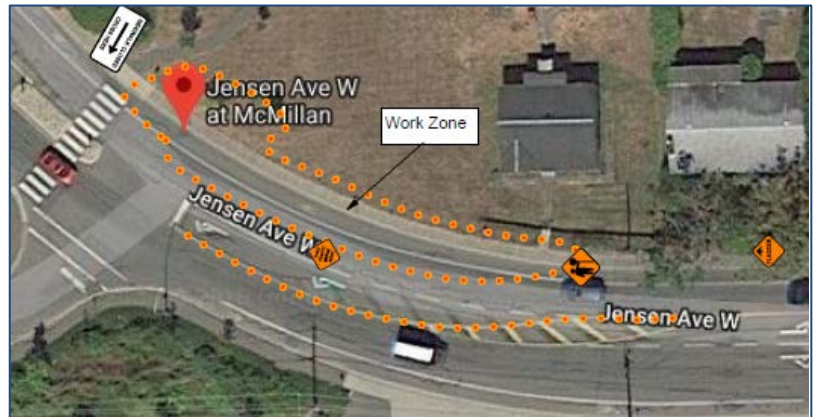

Jensen Avenue East near McCarter

A flagger will direct pedestrians away and/or halt their movement temporarily if required. Stall closures in the Parksville Community Centre parking lot will occur on November 8 and November 9. Please expect periodic lane and sidewalk closures.



Media contact and for more information:

Engineering Department
Deb Tardiff, Manager of Communications

250 951-2484; engineering@parksville.ca
250 954-3073; dtardiff@parksville.ca